

How to access school emails?

STEP 1

Type 'office 365 login
into google (chrome if
possible)

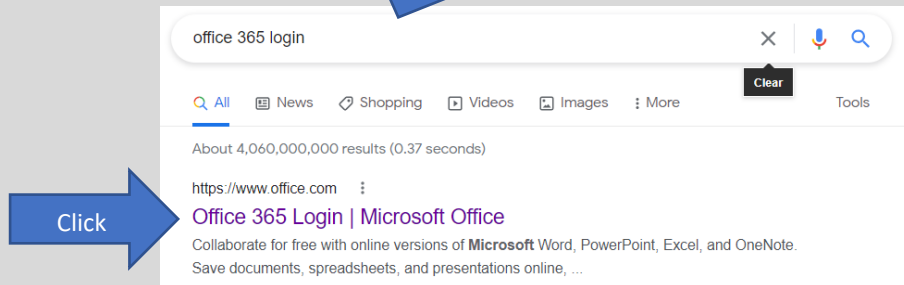

STEP 2

Type in your school
email address
(should be stuck in
your planners)

It is your computer
username followed
by-
[@stu.tla rklt.co.uk](mailto:tl100200@stu.tla.rklt.co.uk)

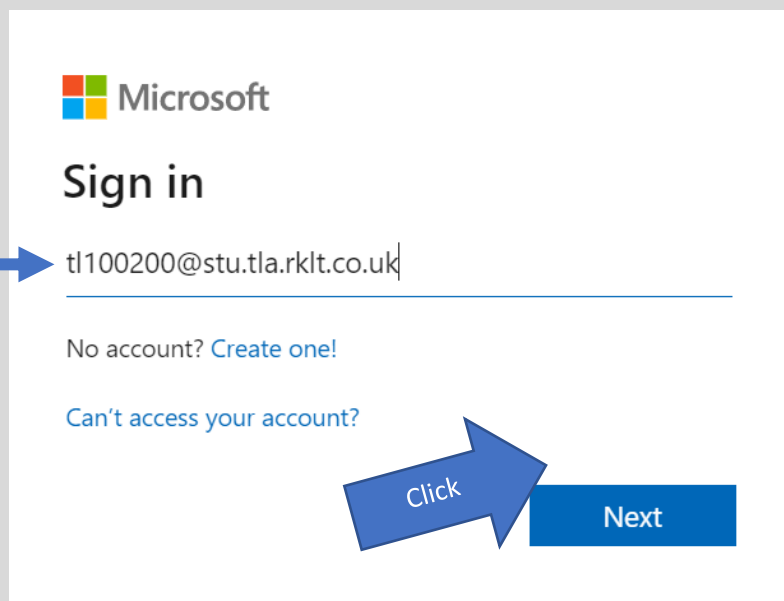
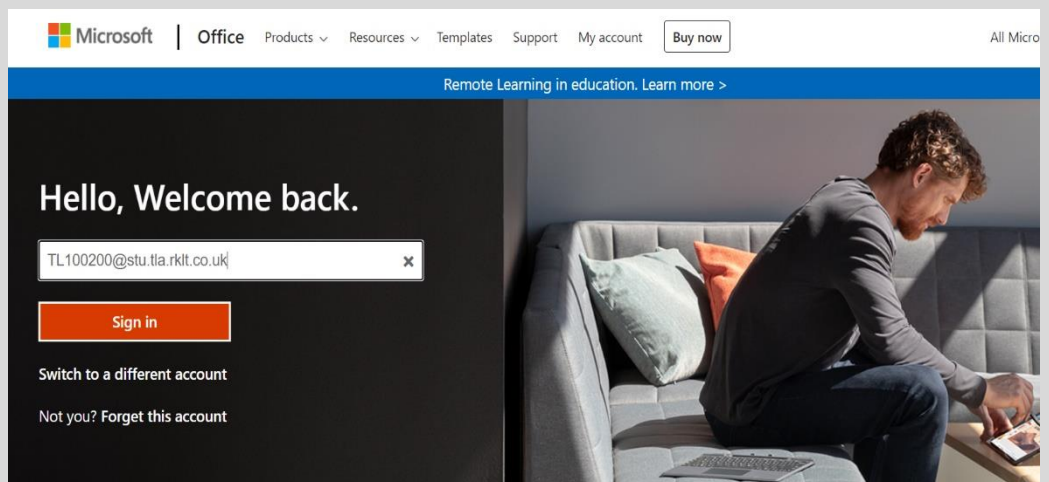

STEP 3

Enter password-
This is the same
password that you
use to access
school computers.

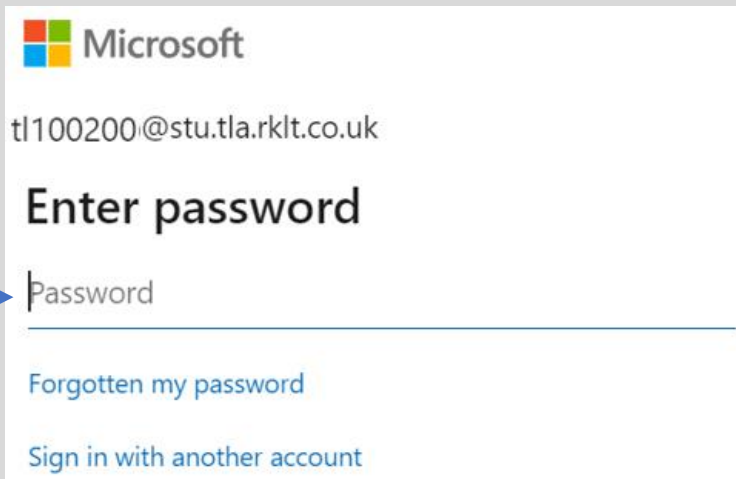

Sign in

Click

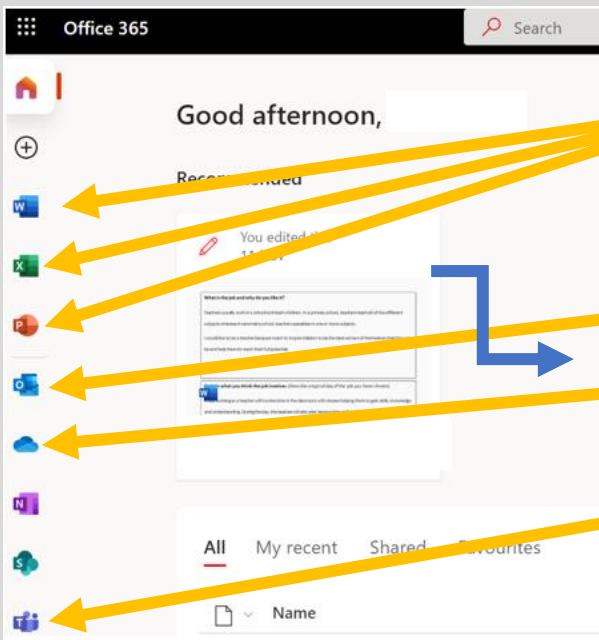

- Students can access Microsoft Word, PowerPoint and Excel as online versions when working at home.
- Outlook to access school emails
- OneDrive to access school their school files and folders.
- TEAMS to access class resources

If the widgets don't
come up on your
browsers, you can press
the 9 dots in the corner
for the same options.

